

# Flat Access Doors – UL Fire Rated

## UL FIRE RATED FLAT ACCESS DOORS

- EASY TO CLEAN AND EASY TO INSTALL
- GASKET RATED TO 2300°F (1260°C) FOR FIRE TIGHT SEAL
- GASKET IS HIGH-TEMP BONDED TO FRONT PANEL
- HEAVY-DUTY 16 GAUGE STEEL CONSTRUCTION
- POSITIVE BOLT PATTERN ENSURES FIRE-SAFE CLOSURE
- BACK FRAME REINFORCES DUCT CUT-OUT

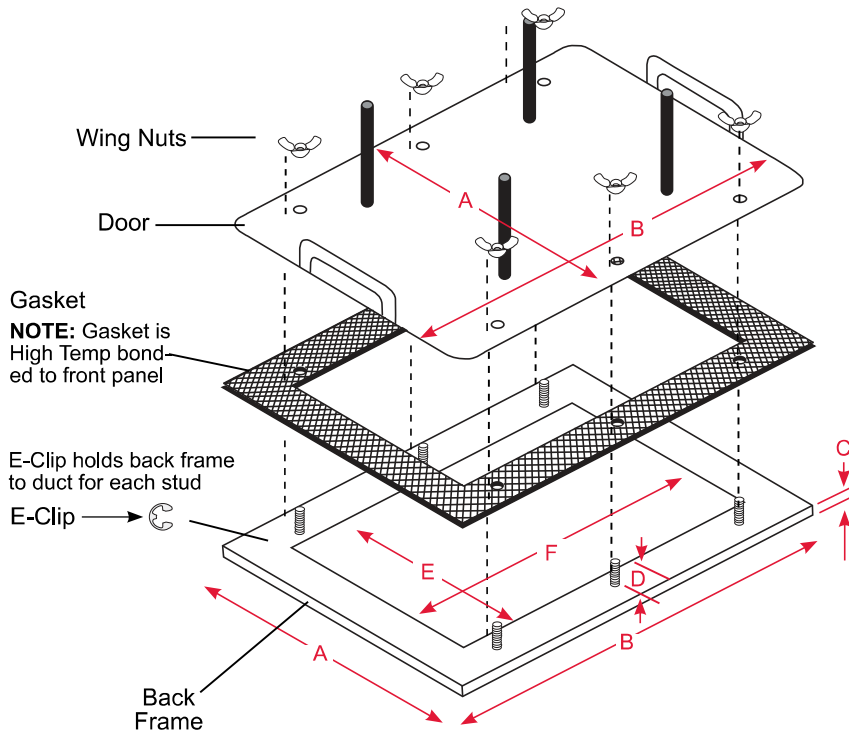

\*\*Access Panels over 7" x 7" (178mm x 178mm) have a 1/2" (13mm) turndown to add rigidity to the panel. Smaller sizes do not have a turndown.



File No. MH16475  
NFPA #96

### FLAT ACCESS DOORS

SKU NO.	PANEL OUTSIDE DIMENSION		PANEL HEIGHT	STUD HEIGHT	HOLE SIZE Inches (mm)		MTG STUDS
	A	B			E	F	
22-750710	7" (178mm)	10" (254mm)	FLAT	1" (25mm)	5.5" (140mm)	8.5" (216mm)	6
22-750715	7" (178mm)	15" (381mm)	FLAT	1" (25mm)	5.5" (140mm)	13.5" (343mm)	6
22-750723	7" (178mm)	23" (584mm)	FLAT	1" (25mm)	5.5" (140mm)	21.5" (546mm)	10
22-750606	8" (203mm)	8" (203mm)	FLAT	1" (25mm)	6" (152mm)	6" (152mm)	4
22-750707	10" (254mm)	10" (254mm)	.5" (13mm)	1" (25mm)	7" (178mm)	7" (178mm)	4
22-750712	10" (254mm)	15" (381mm)	.5" (13mm)	1" (25mm)	7" (178mm)	12" (305mm)	6
22-750720	10" (254mm)	23" (584mm)	.5" (13mm)	1" (25mm)	7" (178mm)	20" (508mm)	10
22-751212	15" (381mm)	15" (381mm)	.5" (13mm)	1" (25mm)	12" (305mm)	12" (305mm)	8
22-751220	15" (381mm)	23" (584mm)	.5" (13mm)	1" (25mm)	12" (305mm)	20" (508mm)	14
22-751620	19" (483mm)	23" (584mm)	.5" (13mm)	1" (25mm)	16" (406mm)	20" (508mm)	16
22-752020	23" (584mm)	23" (584mm)	.5" (13mm)	1" (25mm)	20" (508mm)	20" (508mm)	16